



**College &  
Career for  
All Fund**

Established by Measure N



**OAKLAND UNIFIED  
SCHOOL DISTRICT**

*Community Schools, Thriving Students*

# Aspire Lionel Wilson College Prep

## 2024-2025 Measure Education Improvement Plan Presentation



Presented to Measures N and H Commission

April 18, 2024

[www.ousd.org](http://www.ousd.org)



@OUSDnews

# Lionel Wilson Prep

**Lionel Willson Prep serves the Sobrante Park Community of East Oakland**

**Current Enrollment:** 414

**Demographics:** 95% Latinx, 5% Black

- 27% MLL
- 16% SPED

**Pathway Educators:** 3

## **Our Pathway**

All scholars at LWP participate in our Design for Social Change: An Engineering Pathway. Our pathway follows the CTE standards under the Engineering and Design Pathway. In our pathway, our students engage in the Design Thinking Process to develop products and structures using various software applications. Our students learn Computer Aided Design programs, specifically the Autodesk Suite of programs, which are industry-standard design tools used by engineers, designers, and architects worldwide. Our seniors complete an engineering design capstone, which asks students to use their engineering knowledge, skills, and tools to design a solution to a social justice challenge.

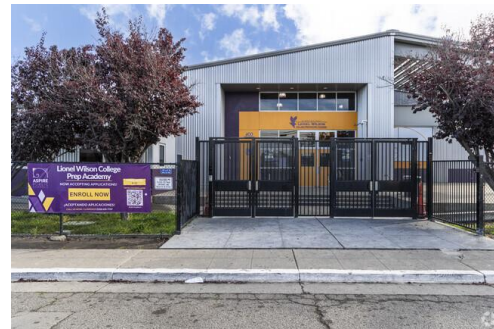

# Design for Social Change: An Engineering Pathway

## Lionel Wilson Prep Pathway Vision

With the support of the community, the students of Lionel Wilson Prep will develop the skills and mindsets necessary to design an equitable reality for themselves, their families, and their communities.

- Ensure that students have the opportunity to engage with rigorous learning experiences grounded in Engineering and Social Justice.
- Strategically partner with organizations like OneGoal, BUILD, Junior Achievement, and other industry partners to support us with internship/work-based learning opportunities.
  - This year, we started a partnership with Earn & Learn, which has resulted in two internship fairs for our students.

<u>9th Grade:</u> BUILD Engineering	<u>10th Grade:</u> PLTW Introduction to Engineering Design	<u>11th Grade:</u> Intermediate Engineering for Social Design	<u>12th Grade:</u> Engineering Design Capstone
63 students	64 students	59 students	61 students

# LWP Celebrations Attributed to Pathway

---

- 2023-2024 U.S. News & World Report Ranked Aspire Lionel Wilson as one of the Best Charter High Schools in California
- Families in Action Recognition for A-G improvement by +20% and +80% Latinx scholars A-G Eligible
- First Oakland CMO with a College and Career Access Pathways with Peralta Community College District
- GoPublicSchools recognition for our 47% MLL reclassification rate
- New partnership with SFSU. Thirty-five of our seniors had on-site acceptances.
- Increased our Black student population from 2% to 5% after consistent a ten-year decline
- Reduction in suspension rate from 8% two years ago to 4% last year. We are projected to be at 2.5% this year.

# Our Partnerships

---



- A new partnership with Earn & Learn resulted in student participation in two internship fairs, one of which occurred on our campus.
- BUILD curriculum supports pathway classes in students learning engineering design projects, capstone projects, and access to professionals through Work-Based Learning Activities.



# Reflections on 2023-24

**Criterion 1: Measures N and H Pathway Improvement Progress Reflection: What has your reflection revealed about progress toward your strategic goals? What progress is evident in your school's reflection on Year 1 (2022-23) strategic actions?**



LWP Sophomore engaging with Fusion 360 Software

- Over the 22-23 school year, we noticed that many of our students with IEPs had difficulty connecting with our pathway as our SPED pathway needed to support all learners.
- In collaboration with our Art teacher, we developed an Arts Integration PLTW course that is an alternative to our mostly digital PLTW course.
- A recent Charter School Growth Fund (CSGF) LWP Alumni Student Survey suggest that participation in the Pathway is one of the most significant experiences they had in High School.
- Dual Enrollment course offerings are on track to be aligned with our Design for Social Change pathway and our College and Career Access Pathway partnership with Peralta Community College District.

# Exhibition Project Collaboration

- Pathway teachers met with education specialists to modify rubrics to align with IEP Goals. One hundred percent of students with IEPs will complete a pathway capstone project.
- Our scholars provided input on their pathway-aligned exhibition projects following an input protocol.

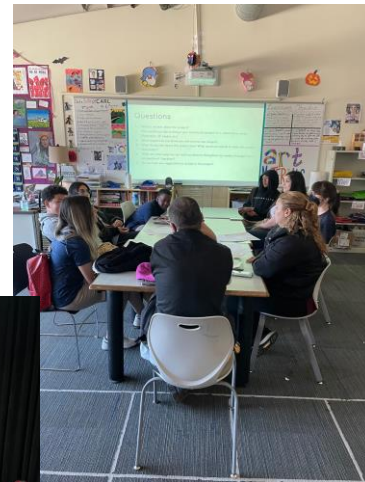



# Senior Capstone

## Senior Defense



**What social issue will the project attempt to address?**

I will be focusing on aiding the housing crisis in the Bay Area.

**What building will I be designing?**

Because I believe that low density multi-family housing would help the housing crisis I will be designing a duplex.

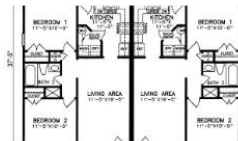

**Why did I choose this?**

I chose the housing crisis because living in Oakland exposes one to high costs of living while in a dangerous and poverty-ridden community. This means residents of Oakland often can't afford to live in a residence that suits their needs. This is worsened by the large amounts of single-family residences which reduce the amount of land that can be used for bigger family housing developments to reduce the housing crisis and decrease high costs of living. Although people don't want the appearance of their community to be affected by large or high-rise buildings and can go as far as to sue their developers there are compromises we can make such as low density multi-family housing which include duplexes, triplexes, and quadruplexes.



**What are the laws and political views around your topic, both now and historically, and how has that affected the issue?**

A solution to the housing crisis has been increasingly difficult to come up with as political parties become more and more divided on most topics. Even in liberal states, such as California, communities disapprove of the construction of affordable housing and nursing homes despite their votes for it. The project was approved unanimously by the nine-member city council in June, but thousands of residents signed petitions to force a public vote...They don't think the council is paying attention to what the community wants. They don't think that the developers give a damn. All the developers want is maximum profit. If they can jam more in, they'll jam more in." (The Mercury News, Jason Green) These views—the construction of affordable profit for maximum profit—are often shared with conservatives despite that being far from the truth.

**What ideas have been proposed and/or tried? What worked and what didn't?**

**What roadblocks are there preventing these strategies from being successful?**



While people claim that any type of housing, from affordable to expensive, will help in aiding the housing crisis, developers prefer to focus on building residences that bring in higher profits. They have found that oftentimes the construction of affordable and high-density housing is too much of a financial risk because of its high cost and low profit margins. To lessen the risk and encourage developers to build affordable housing, governments have given tax subsidies but oftentimes even this is not enough.

"The practice of requiring market-rate developments to include a certain percentage of below-market-rate units is a dangerous game. Set the percentage too high and the city ends up with fewer total units, which drives up costs for everyone. The San Francisco market is strong enough that it can sustain this approach of taking housing to produce housing, but an increase of the inclusionary zoning rate to even 17% will create a housing cost burden for 2,196 households." ( )

Like I previously said, California introduced a law that banned new single-family zoning but according to the Los Angeles Times "...the radical change in policy has been decidedly unradical in practice. A new study found that Senate Bill 9, which allows up to four units on a single-family lot, [has barely been used](#)."



**Why is the housing crisis so complex to solve?**

This issue is complex to solve because of a combination of the public's



# Reflections on 2023-24

**Criterion 2: Measures N and H Pathway Improvement Plan (Actions): What new or revised strategic actions will the school and pathways undertake in the coming year to continue to make progress toward three-year goals? How will these actions impact student achievement and experience to improve school-wide goals?**

## Strategic Action Steps: Pathways

- We will use our current connections and develop new partnerships, such as Earn & Learn and Junior Achievement, to increase opportunities for WBL.
- We developed a College and Career Access Pathways (CCAP) with the Peralta Community College District to expand dual enrollment offerings aligned to our pathway and ethnic studies for students. We are offering these courses on our campus to remove transportation costs and needs.
- The pathway coordinator will work with the instructional leadership team and pathway-enrolled students to present professional development to faculty on elements of a high-quality capstone and projects. Our students will project input into their pathway-aligned exhibition projects.

## Strategic Action Steps: School

- We will increase academic support by restructuring our special education department & shifting to an inclusion co-teaching model to support our scholars with learning exceptionalities.
- We launched a College and Career Center to offer all scholars comprehensive college and career awareness.
- We will offer students a pathway-aligned integrated project each semester. By the time they graduate, students will have completed eight projects.
- We will attend the Linked Learning Conference to better educate ourselves on the steps needed to obtain the Linked Learning Gold Certification.

# Reflections on 2023-24: Equity

## How are your Pathway(s) helping to close equity gaps for your focal population?

- With the shift to a co-teaching model with our Special Education team and regularly scheduled collaboration meetings, our team has been able to ensure the following:
  - 100% of our SpEd population participates in our pathways.
  - 100% of our Multilingual Learners (MLL) participate in our pathways.
  - MLL supports are integrated during lesson planning
  - All student projects and lessons are framed around Social Justice topics or current events that impact our community, and students can discuss, ideate, and create solutions to the challenges at hand using the design thinking process.
  - Partnerships will also give focal students access to more WBL opportunities that can support their transition into college or careers.



# Reflections on 2023-24

Criterion 3: How will Measures N and H funds support strategic actions and progress toward goals?

Expense	Rationale
Pathway Coordinator	Develop LWP pathway, integrate pathway into instructional programming, and develop WBL continuum
Project Lead the Way Teacher	Facilitate pathway aligned course PLTW and collaborate with education specialists
Engineering Teacher	Facilitate BUILD Engineering Design, Engineering Design Capstone and collaborate with education specialists
College and Career Readiness Teacher	Support LWP scholars with post High School transition plans in collaboration with OneGoal Partnership
Linked Learning Conference	Deepen knowledge of how to enhance our program

# Questions?

