

Board Office Use: Legislative File Info.	
File ID Number	13-1666
Committee	Facilities
Introduction Date	8-14-2013
Enactment Number	13-1565
Enactment Date	8/14/13



OAKLAND UNIFIED
SCHOOL DISTRICT

Community Schools, Thriving Students

Memo

To Board of Education
From Gary Lee, Ed.D.
 Tony Smith, Ph.D., Superintendent
 Timothy White, Associate Superintendent, Facilities Planning and Management

Board Meeting Date August 14, 2013

Subject Amendment No. 2, Purchase Order Contract - RMT Landscape Contractors, Inc.-
 Claremont Landscaping Project

Action Requested Approval by the Board of Education of Amendment No.2, Purchase Order Contract with RMT Landscape Contractors, Inc. for Landscaping Services on behalf of the District at Claremont Landscaping Project, in an amount not-to exceed \$8,700.00 increasing previous contract amount from \$34,192.00 to a not to exceed amount of \$42,892.00 and revising the end date from October 16, 2012 through December 31, 2013 to December 31, 2014. All remaining portions of the agreement shall remain in full force and effect as originally stated.

Background Per site request for 100th Year Celebration.

Local Business Participation Percentage 100.00%

Strategic Alignment Among the key purposes of the District's Facilities Master Plan is to provide an academic environment for the Oakland community that will give every student, educator, and community member using our facilities the best possible opportunity for learning.

Through implementation of the Facilities Master Plan, the District intends to improve the District's facilities in terms of structural integrity, safety, reliability of operating (mechanical) systems, access to modern resources,



number and type of appropriate laboratories and specialized instruction rooms, opportunities for physical education, and attractiveness, such that the Oakland Public Schools are second to none. Operation of the District schools under the planned approach is intended to ensure safety, cleanliness, and orderliness for all individuals participating in the learning process.

The basic facility needs of students such as proper lighting, functional roofs, noise control and well maintained buildings, not only convey the message that we value our students and teachers but may foster a sense of school pride and community ownership which may improve attitudes towards learning. The implementation of the Facilities Master Plan is our first step in that direction.

Recommendation

Approval by the Board of Education of Amendment No.2, Purchase Order Contract with RMT Landscape Contractors, Inc. for Landscaping Services on behalf of the District at Claremont Landscaping Project, in an amount not-to exceed \$8,700.00 increasing previous contract amount from \$34,192.00 to a not to exceed amount of \$42,892.00 and revising the end date from October 16, 2012 through December 31, 2013 to December 31, 2014. All remaining portions of the agreement shall remain in full force and effect as originally stated.

Fiscal Impact

The funding source for this project is General Obligation Bond-Measure A

Attachments

- Purchase Order Contract including scope of work



OAKLAND UNIFIED
SCHOOL DISTRICT

Community Schools, Thriving Students

File ID Number: 13-1666
 Introduction Date: 8/14/13
 Enactment Number: 13-1565
 Enactment Date: 8/14/13
 By: AS

**AMENDMENT NO. 2 TO INDEPENDENT
CONSULTANT CONTRACT**

This Amendment is entered into between the Oakland Unified School District (OUSD) and RMT Landscape Contractors. OUSD entered into an Agreement with CONTRACTOR for services on October 24, 2012, and the parties agree to amend that Agreement as follows:

1. Services:	<input type="checkbox"/> The scope of work is <u>unchanged</u> .	<input checked="" type="checkbox"/> The scope of work has <u>changed</u> .
<p>If scope of work changed: Provide brief description of revised scope of work including description of expected final results, such as services, materials, products, and/or reports; attach additional pages as necessary. <u>Attach revised scope of work.</u></p> <p>The CONTRACTOR agrees to provide the following amended services: <u>The scope of the project is to install 150 cubic yards of mulch, and install forty (40) 5-gallon shrubs.</u></p>		
2. Terms (duration):	<input type="checkbox"/> The term of the contract is <u>unchanged</u> .	<input checked="" type="checkbox"/> The term of the contract has <u>changed</u> .
<p>If term is changed: The contract term is extended by an additional <u>One year</u>, and the amended expiration date is <u>December 31, 2014</u>.</p>		
3. Compensation:	<input type="checkbox"/> The contract price is <u>unchanged</u> .	<input checked="" type="checkbox"/> The contract price has <u>changed</u> .
<p>If the compensation is changed: The contract price is amended by</p> <p><input checked="" type="checkbox"/> <u>Increase of \$8,700.00 to original contract amount</u></p> <p><input type="checkbox"/> Decrease of \$ _____ to original contract amount</p> <p>and the new contract total is <u>Forty-two thousand, eight hundred ninety-two dollars and no cents (\$42,892.00.00)</u></p>		

4. **Remaining Provisions:** All other provisions of the Agreement, and prior Amendment(s) if any, shall remain unchanged and in full force and effect as originally stated.

5. **Amendment History:**

There are no previous amendments to this Agreement. This contract has previously been amended as follows:

No.	Date	General Description of Reason for Amendment	Amount of Increase (Decrease)
1	6-26-2013	The Garden Committee requested additional landscaping.	\$9,112.00

6. **Approval:** This Agreement is not effective and no payment shall be made to Contractor until it is approved. Approval requires signature by the Board of Education, and the Superintendent as their designee.

OAKLAND UNIFIED SCHOOL DISTRICT

[Signature]
David Katschiba, President,
Board of Education

8/15/13
Date

[Signature]
Gary Yee, Ed.D., Secretary
Board of Education

8/15/13
Date

[Signature]
Timothy White, Associate Superintendent
Facilities, Planning and Management

Date

CONTRACTOR

[Signature] 7/10/13
Contractor Signature Date

SALLY A LIPSKA CORP SECTY
Print Name, Title

EXHIBIT "A" Scope of Work

Contractor Name:

Billing Rate: Eight thousand, seven hundred dollars and no cents (\$8,700.00)

1. Description of Services to be Provided

The scope of the project is to provide landscape service.

2. Specific Outcomes:

Create equitable opportunities for learning. Accountable for quality.

3. Alignment with District Strategic Plan: Indicate the goals and visions supported by the services of this contract:

<input type="checkbox"/> Ensure a high quality instructional core	<input type="checkbox"/> Prepare students for success in college and careers
<input type="checkbox"/> Develop social, emotional and physical health	<input type="checkbox"/> Safe, healthy and supportive schools
<input checked="" type="checkbox"/> Create equitable opportunities for learning	<input checked="" type="checkbox"/> Accountable for quality
<input type="checkbox"/> High quality and effective instruction	<input type="checkbox"/> Full service community district

Certification Regarding Debarment, Suspension, Ineligibility and Voluntary Exclusion: The District certifies to the best of its knowledge and belief, that it and its officials: Are not presently debarred, suspended, proposed for debarment, declared ineligible, or voluntarily excluded from covered transactions by any Federal department or agency according to Federal Acquisition Regulation Subpart 9.4, and by signing this contract, certifies that this vendor does not appear on the Excluded Parties List. <https://www.sam.gov/portal/public/SAM>

Susie Butler-Berkley 7-15-2013

**Susie Butler-Berkley
Contract Analyst**

RMT LANDSCAPE CONTRACTORS, Inc.

421 Pendleton Way, Oakland, CA 94621

Contractor's License No. 372869

INVOICE

Oakland Unified School District
955 High Street
Oakland, CA 94601

INVOICE NO 19912
JOB NO A653
Date: 7/9/2013
P.O. # 1303957

Re: Claremont Middle School

Description:

Original Purchase Order Amount	\$25,080.00
Add Amendment No. 1	\$9,112.00
Add Amendment No. 2	<u>\$8,700.00</u>
Total Purchase Order	\$42,892.00
Total complete - 100%	\$42,892.00
Less Previous Payment	<u>\$34,192.00</u>
Amount Due	\$8,700.00

Terms:

Net

CC: Rocky Borton
SGI Construction Management
360 - 22nd St, Ste 620
Oakland, CA

Architectural Supplementary Instruction: ASI # 31.1 r.1
dated 4/24/13

TITLE: Clarification of finishes, tackboards

PROJECT: Havenscourt Middle School DATE: 4/22/13
DSA application #01-111714

ARCHITECT: S Meek Architecture OUSD PROJECT: #07030-2

DISTRICT: Oakland Unified School District (OUSD)

The owner is considering the following change(s) to the contract. Please review this change and advise the owner in writing of any cost and/or time impacts.

DESCRIPTION OF CHANGE

Change to the following:

1) The tackboards at the second floor classrooms and at the 2nd floor corridor wall have revised dimensions per the following:

a) at the wall against the corridor (north elevation in classrooms D24, D25, D26)(south elevation in classrooms D21, D22, D23), the tackboard TB-3 shall be 18" wide on each side – See SK-A112

b) At the corridor, the TB-2 shall be 4' tall on both North and South side. See SK-A114. Provide credit to owner for material (originally TB was almost 8' tall)

and SK-A114.1

REASON FOR CHANGE:

Clarification dimension

r.1 changes:
include SK-A114.1 to illustrate
the entire length of the corridor

Attachments:

- SK-A112 revision to 1S/A5.7, dated 4/22/13
- SK-A114 revision to 1/A5.5, dated 4/22/13
- and SK-A114.1 revision to 1/A5.5 dated 4/24/13

END OF ASI #31.1 r.1

Swannah Meek

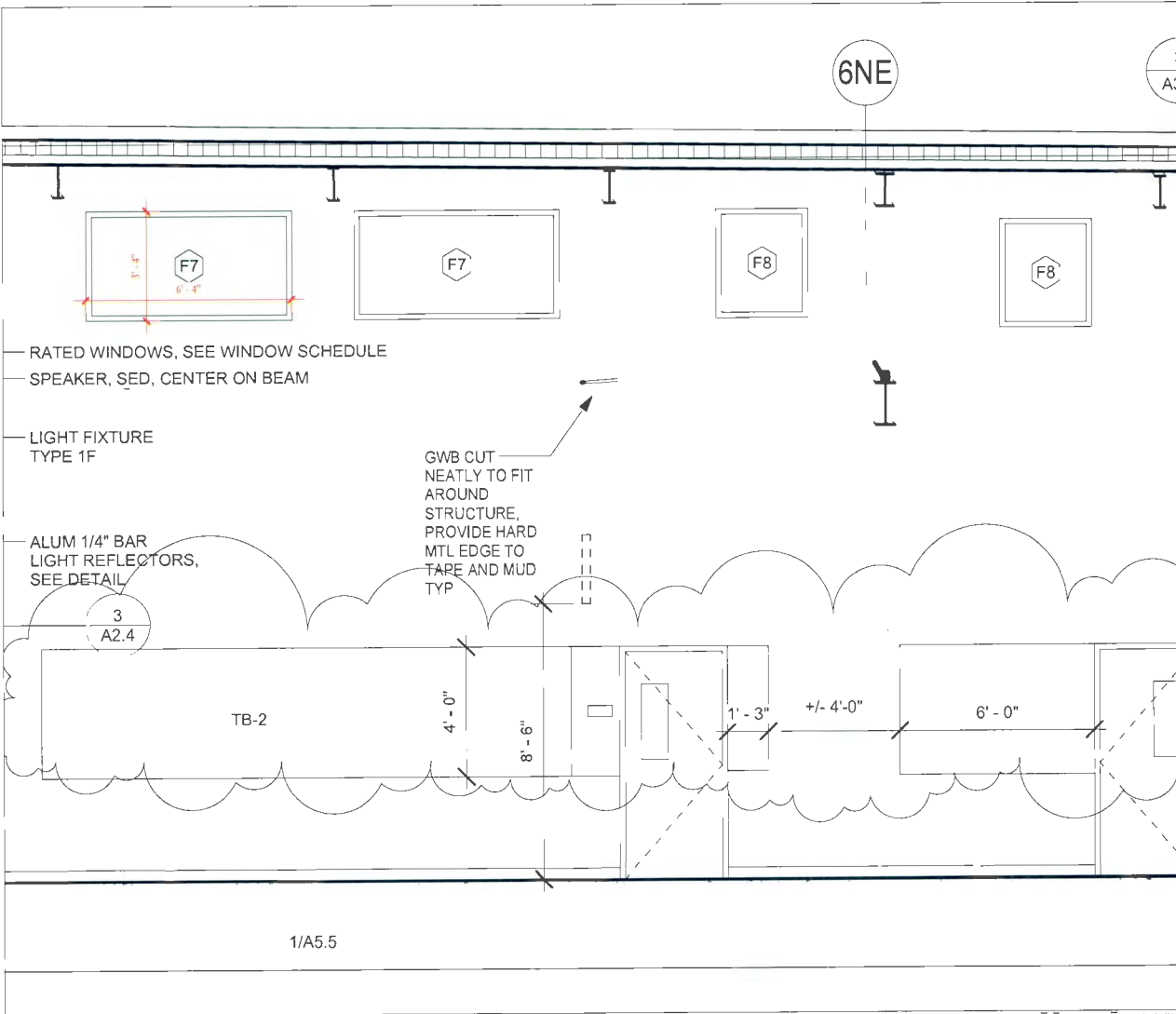

— RATED WINDOWS, SEE WINDOW SCHEDULE
 — SPEAKER, SED, CENTER ON BEAM
 — LIGHT FIXTURE TYPE 1F

GWB CUT
 NEATLY TO FIT
 AROUND
 STRUCTURE,
 PROVIDE HARD
 MTL EDGE TO
 TARE AND MUD
 TYP

ALUM 1/4" BAR
 LIGHT REFLECTORS,
 SEE DETAIL

3
A2.4

TB-2

4'-0"

8'-6"

1'-3"

+/- 4'-0"

6'-0"

1/A5.5

6NE

A3

DSA# 01-111714
 SCALE: 1/4"=1'-0"
 date 4/22/13
 ASI #31.1
 SK-A114

SHEET TITLE:
 A5.5 INTERIOR ELEVATIONS

Havenscort Middle School
 New Classroom and Cafeteria Building Phase 2
 1390 66th Ave.
 Oakland, CA 94621
 OUSD# 07030.2 SMA# 0903

S MEEK Architecture
 3040 24th Street, San Francisco, CA 94110
 p: 415-543-5505
 f: 415-543-5585

C:\Revit Local Project Files\Havenscort_Central CA_Susanah.rvt

2W CLASSROOM D23, WEST
 A5.7 1/4" = 1'-0"

17'-0"

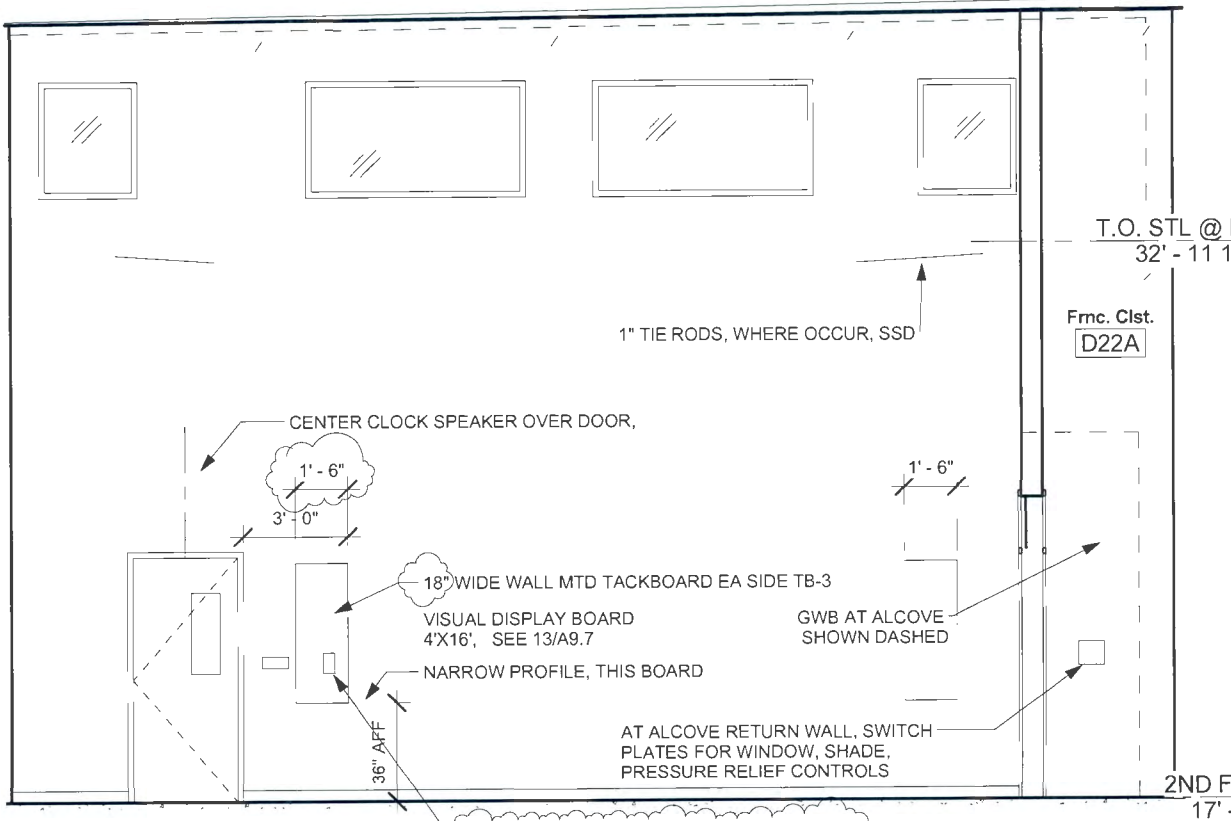

1S CLASSROOM D22, SOUTH
 A5.7 1/4" = 1'-0"

2ND F
 17'

DSA# 01-111714
 SCALE: 1/4" = 1'-0"
 ASI 31.1 4/22/13
 SK-A112

SHEET TITLE:
 A5.7 INTERIOR ELEVATIONS

Havenscourt Middle School
 New Classroom and Cafeteria Building Phase 2
 1390 66th Ave.
 Oakland, CA 94621
 OUSD# 07030-2 SMA# 0903
 S MEEK Architecture

f: 415-543-5585
 p: 415-543-5505
 3040 24th Street, San Francisco, CA 94110

A5.5

SK-114.1
4/24/13
ASI 31.11
Havenscourt

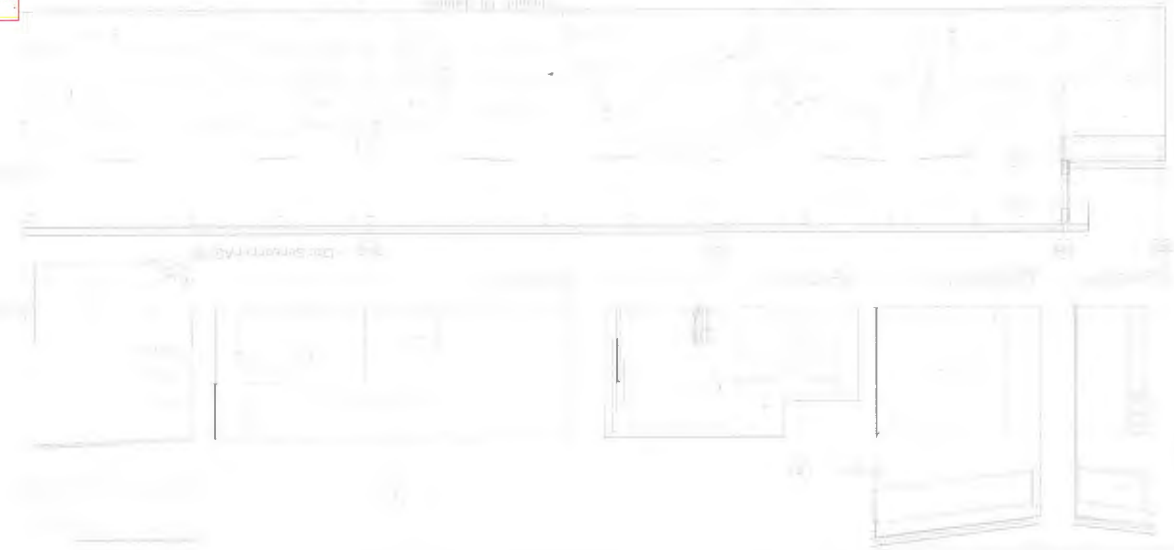
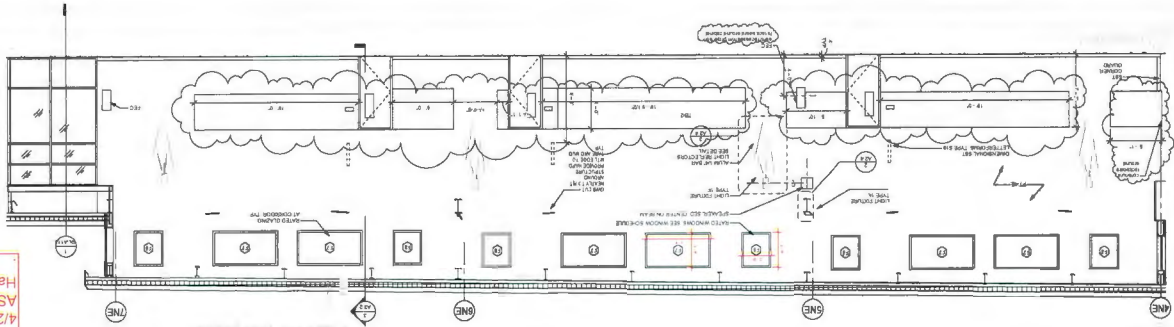

THIS ENDORSEMENT CHANGES THE POLICY. PLEASE READ IT CAREFULLY.

**ADDITIONAL INSURED – OWNERS, LESSEES OR
CONTRACTORS – COMPLETED OPERATIONS**

This endorsement modifies insurance provided under the following:

COMMERCIAL GENERAL LIABILITY COVERAGE PART

SCHEDULE

Name Of Additional Insured Person(s) Or Organization(s):	Location And Description Of Completed Operations
<p>Blanket as required by written contract and effective during the policy period as stated on the policy declarations.</p>	<p>Blanket as required by written contract. Primary Insurance applies: It is agreed that such insurance as is afforded by this policy for the benefit of the additional insured shown shall be primary insurance, and any other insurance maintained by the additional insured(s) shall be excess and noncontributory as respects any claim, loss or liability allegedly arising out of the operations of the named insured, provided however that this insurance will not apply to any claim loss or liability which is determined to be solely the result of the additional insured's negligence or solely the additional insured's responsibility. This insurance also does not apply to any structure intended to be occupied as a private residence, not including apartments.</p>

Information required to complete this Schedule, if not shown above, will be shown in the Declarations.

Section II – Who Is An Insured is amended to include as an additional insured the person(s) or organization(s) shown in the Schedule, but only with respect to liability for "bodily injury" or "property damage" caused, in whole or in part, by "your work" at the location designated and described in the schedule of this endorsement performed for that additional insured and included in the "products-completed operations hazard".

THIS ENDORSEMENT CHANGES THE POLICY. PLEASE READ IT CAREFULLY.

**WAIVER OF TRANSFER OF RIGHTS OF RECOVERY
AGAINST OTHERS TO US**

This endorsement modifies insurance provided under the following:

COMMERCIAL GENERAL LIABILITY COVERAGE PART

SCHEDULE

Name of Person or Organization:

Blanket as required by written contract and effective during the policy period as stated on the policy declarations.

If no entry appears above, information required to complete this endorsement will be shown in the Declarations as applicable to this endorsement.

The TRANSFER OF RIGHTS OF RECOVERY AGAINST OTHERS TO US Condition (Section IV - COMMERCIAL GENERAL LIABILITY CONDITIONS) is amended by the addition of the following:

We waive any right of recovery we may have against the person or organization shown in the Schedule above because of payments we make for injury or damage arising out of your ongoing operations or "your work" done under a contract with that person or organization and included in the "products-completed operations hazard". This waiver applies only to the person or organization shown in the Schedule above.

Board Office Use: Legislative File Info.	
File ID Number	13-1589
Committee	Facilities
Introduction Date	6-26-2013
Enactment Number	13-1482
Enactment Date	6/26/13 <i>ps</i>



OAKLAND UNIFIED SCHOOL DISTRICT

Learning Schools. Thriving Students.

Memo

To Board of Education

From Tony Smith, Ph.D., Superintendent
Timothy White, Associate Superintendent, Facilities Planning and Management *[Signature]*

Board Meeting Date June 26, 2013

Subject Amendment No. 1, Purchase Order Agreement - RMT Landscape Contractors, Inc. - Claremont Landscaping Project

Action Requested Approval by the Board of Education of Amendment No. 1, Purchase Order Agreement with RMT Landscape Contractors for Landscape Services on behalf of the District at Claremont Middle School Landscaping Project, in an amount not-to exceed \$9,112.00 increasing previous contract amount from \$25,080.00 to a not to exceed amount of \$34,192.00. All remaining portions of the agreement shall remain in full force and effect as originally stated.

Background Site request by the garden committee.

Local Business Participation Percentage 100.00%

Strategic Alignment Among the key purposes of the District's Facilities Master Plan is to provide an academic environment for the Oakland community that will give every student, educator, and community member using our facilities the best possible opportunity for learning.

Through implementation of the Facilities Master Plan, the District intends to improve the District's facilities in terms of structural integrity, safety, reliability of operating (mechanical) systems, access to modern resources,



number and type of appropriate laboratories and specialized instruction rooms, opportunities for physical education, and attractiveness, such that the Oakland Public Schools are second to none. Operation of the District schools under the planned approach is intended to ensure safety, cleanliness, and orderliness for all individuals participating in the learning process.

The basic facility needs of students such as proper lighting, functional roofs, noise control and well maintained buildings, not only convey the message that we value our students and teachers but may foster a sense of school pride and community ownership which may improve attitudes towards learning. The implementation of the Facilities Master Plan is our first step in that direction.

Recommendation

Approval by the Board of Education of Amendment No. 1, Purchase Order Agreement with RMT Landscape Contractors for Landscape Services on behalf of the District at Claremont Middle School Landscaping Project, in an amount not-to exceed \$9,112.00 increasing previous contract amount from \$25,080.00 to a not to exceed amount of \$34,192.00. All remaining portions of the agreement shall remain in full force and effect as originally stated.

Fiscal Impact

Measure A

Attachments

- Purchase Order Agreement including scope of work



OAKLAND UNIFIED SCHOOL DISTRICT

Community Schools, Thriving Students

File ID Number: 13-1584
 Introduction Date: 6/26/13
 Enactment Number: 13-1482
 Enactment Date: 6/26/13
 By: OL

AMENDMENT NO. 1 TO PURCHASE ORDER CONTRACT

This Amendment is entered into between the Oakland Unified School District (OUSD) and RMT Landscape Contractors Inc. OUSD entered into an Agreement with CONTRACTOR for services on October 24, 2013, and the parties agree to amend that Agreement as follows:

1. **Services:** The scope of work is unchanged. The scope of work has changed.
 If scope of work changed: Provide brief description of revised scope of work including description of expected final results, such as services, materials, products, and/or reports; attach additional pages as necessary. Attach revised scope of work.
 The CONTRACTOR agrees to provide the following amended services: The scope of the project is to install two (2) fifteen gallon western redbud, install 123 (5) shrubs, install 109 (1) gal shrubs, install owner supplied pavers at entrance to garden.

2. **Terms (duration):** The term of the contract is unchanged. The term of the contract has changed.
 If term is changed: The contract term is extended by an additional _____ (days/weeks/months), and the amended expiration date is _____, 20____.

3. **Compensation:** The contract price is unchanged. The contract price has changed.
 If the compensation is changed: The contract price is amended by
 Increase of \$9,112.00 to original contract amount
 Decrease of \$ _____ to original contract amount
 and the new contract total is Thirty-four thousand, one hundred ninety-two dollars and no cents (\$34,192.00)

4. **Remaining Provisions:** All other provisions of the Agreement, and prior Amendment(s) if any, shall remain unchanged and in full force and effect as originally stated.

5. **Amendment History:**

There are no previous amendments to this Agreement. This contract has previously been amended as follows:

No.	Date	General Description of Reason for Amendment	Amount of Increase (Decrease)
			\$

6. **Approval:** This Agreement is not effective and no payment shall be made to Contractor until it is approved. Approval requires signature by the Board of Education, and the Superintendent as their designee.

OAKLAND UNIFIED SCHOOL DISTRICT

David Kakoshija, President,
Board of Education

Edgar Rakestraw, Jr., Secretary
Board of Education

Timothy White, Associate Superintendent
Facilities, Planning and Management

6/27/13
Date

6/27/13
Date

6/19/13
Date

CONTRACTOR

Contractor Signature

Print Name, Title

6/5/13
Date

EXHIBIT "A" Scope of Work

Contractor Name: RMT Landscape Contractors, Inc.

Billing Rate: Nine thousand, one hundred twelve dollars and no cents (\$9,112.00)

1. Description of Services to be Provided

The scope of the project is to install two (2) fifteen gallon western redbud, install 123-(5) shrubs, install 109 (1) gal shrubs, install owner supplied pavers at entrance to garden.

2. Specific Outcomes:

Create equitable opportunities for learning.

3. Alignment with District Strategic Plan: Indicate the goals and visions supported by the services of this contract:

<input type="checkbox"/> Ensure a high quality instructional core	<input type="checkbox"/> Prepare students for success in college and careers
<input type="checkbox"/> Develop social, emotional and physical health	<input checked="" type="checkbox"/> Safe, healthy and supportive schools
<input checked="" type="checkbox"/> Create equitable opportunities for learning	<input checked="" type="checkbox"/> Accountable for quality
<input type="checkbox"/> High quality and effective instruction	<input type="checkbox"/> Full service community district

Certification Regarding Debarment, Suspension, Ineligibility and Voluntary Exclusion: The District certifies to the best of its knowledge and belief, that it and its officials: Are not presently debarred, suspended, proposed for debarment, declared ineligible, or voluntarily excluded from covered transactions by any Federal department or agency according to Federal Acquisition Regulation Subpart 9.4, and by signing this contract, certifies that this vendor does not appear on the Excluded Parties List: <https://www.sam.gov/portal/public/SAM>

Susie Butler-Berkley

**Susie Butler-Berkley
Contract Analyst**

EXHIBIT A



LANDSCAPE CONTRACTORS, INC.

7699 Edgewater Drive
Oakland, CA 94621

Contractor's License No. 372869

PROPOSAL & CONTRACT

Name:	OUSD	Date:	04/26/13
Attention:	Rocky	Phone:	333-0662
Address:	955 High Street	E-mail:	rocl.borton@ousd.k12.ca.us
	Oakland, Ca.		
Job Location:	Claremont School		

Work to be performed as follows.

- 1) install 2- (15) gal Western redbud
- 2) install 123- (5) shrubs (as per list)
- 3) 109- (1) gal. shrubs (as per list)
- 4) install owner supplied pavers at entrance to garden

TOTAL:	\$9,112.00
--------	------------

We agree to supply labor and materials in order to execute the work as outlined above in a workmanlike manner in a workmanlike manner for the sum of \$ 9112.00 which the owner agrees to pay in accordance with the terms of payment set forth.

TERMS OF PAYMENT:
NET: Payment on Completion

RMT LANDSCAPE CONTRACTORS, INC.

By: _____

Title: President _____

Accepted by: _____

Date: _____

Owner's Signature: _____

Board Office Use: Legislative File Info.	
File ID Number	13-0804
Committee	Facilities
Introduction Date	5-8-2013
Enactment Number	13-0795
Enactment Date	5/8/13 o.s.



OAKLAND UNIFIED
SCHOOL DISTRICT

Memo

To Board of Education

From Tony Smith, Ph.D., Superintendent
Timothy White, Associate Superintendent, Facilities Planning and Management

Board Meeting Date May 8, 2013

Subject Division of Facilities Planning and Management P.O's. Less than \$50,000.00

Action Requested: Ratification by the Board of Education of the attached contracts for the Division of Facilities Planning and Management.

Legistar #	Name	Amount	Funding Source	P.O.	Project	Date	City
13-0796	Apple Inc.	\$1,974.009	Measure A	P.O.	Facilities	12-4-12 thru 12-4-13	Cupertino
13-0797	Chussy International	\$620.20	Measure A	P.O.	Facilities	10-10-12 thru 11-10-12	Oakland
13-0798	Chussy International	\$350.00	Measure A	P.O.	Facilities	12-7-12 thru 12-7-12	Oakland
13-0799	Comtel Systems	\$7,784.00	County School Facilities Fund	P.O.	La Escuelita Educational Center	11-7-12 thru 3-31-13	Sunnyvale
13-0804	Dell	\$3,887.02	Measure A	P.O.	Facilities	11-29-12 thru 12-28-12	Round Rock, TX
13-0805	DFS	\$17,025.00	Developer Fee	P.O.	Facilities	12-1-12 thru 1-31-13	Foster City
13-0806	Goodman Manufacturing Corp.	\$190,100.00	Special Funding	P.O.	Stonehurst 3 Multizone HVAC Units	11-4-12 thru 1-5-13	Roseville, CA
13-0807	Graninger	\$156.71	Measure A	P.O.	Facilities	10-16-12 thru 11-15-12	San Leandro
13-0808	Humanized Productions	\$15,000.00	Measure B	P.O.	Facilities	10-1-2012 thru 6-30-13	Oakland
13-0809	Integrity Painting Company	\$12,718.00	Special Funding	P.O.	Facilities	7-13-12 thru 6-30-13	Oakland
13-0810	Marketing VUE	\$1,320.84	Special Funding	P.O.	Facilities	10-31-12 thru 11-30-12	Wayland, MA
13-0811	PG&E	\$1,500.00	Measure B	P.O.	Arroyo Viejo	10-22-12 thru 12-31-13	Sacramento
13-0812	Ricoh USA, Inc.	\$4,000.00	Measure A	P.O.	Facilities	6-30-12 thru 6-30-13	Malvern, PA
13-0813	R&S Overhead Garage Door, Inc.	\$14,124.00	County School Facilities Fund	P.O.	Oakland Tech Seismic Retrofit	10-16-12 thru 12-31-13	San Leandro



OAKLAND UNIFIED SCHOOL DISTRICT

✓ 13-0814	RMT Landscape Contractors, Inc.	\$25,080.00	Measure A	P.O.	Claremont Landscaping	10-16-12 thru 12-31-13	Oakland
13-0815	Syska Hennessy Group	\$6,880.00	Measure B	P.O.	Highland New Classroom	10-22-12 thru 12-31-13	San Francisco
13-0816	Syska Hennessy Group	\$3,755.00	Developer Fee	P.O.	La Escuelita Educational Center	11-15-12 thru 1-15-13	San Francisco

Discussion:

Among the key purposes of the District's Facilities Master Plan is to provide an academic environment for the Oakland community that will give every student, educator, and community member using our facilities the best possible opportunity for learning.

Through implementation of the Facilities Master Plan, the District intends to improve the District's facilities in terms of structural integrity, safety, reliability of operating (mechanical) systems, access to modern resources, number and type of appropriate laboratories and specialized instruction rooms, opportunities for physical education, and attractiveness, such that the Oakland Public Schools are second to none. Operation of the District schools under the planned approach is intended to ensure safety, cleanliness, and orderliness for all individuals participating in the learning process.

The basic facility needs of students such as proper lighting, functional roofs, noise control and well maintained buildings, not only convey the message that we value our students and teachers but may foster a sense of school pride and community ownership which may improve attitudes towards learning. The implementation of the Facilities Master Plan is our first step in that direction.

Fiscal Impact:

Various

Recommendation:

The Board of Education is requested to approve the Facilities Planning and Management contracts and Purchase Order for the OUSD school sites.

OAKLAND UNIFIED SCHOOL DISTRICT
Department of Facilities Planning and Management
AGREEMENT REQUEST FORM

1001404

DATE SUBMITTED: 9/21/2012
 SUBMITTED BY: Rocky Borton

REVIEWED BY: _____

SECTION I. TYPE OF AGREEMENT (PLEASE CHECK ONE BOX)

Bond Program Director

1.) A/E (Architect and Engineers) Contract	<input type="checkbox"/>	5.) "Small" (under \$15,000.00) Construction Contract	<input type="checkbox"/>
2.) IOR (Inspector of Record Contract)	<input type="checkbox"/>	6.) Resolution Awarding Bid and Construction Contract	<input type="checkbox"/>
3.) Agreement for Professional Services - Testing Etc.	<input type="checkbox"/>	7.) Change Order	<input type="checkbox"/>
4.) Amendment to Agreement for Professional Services	<input type="checkbox"/>	8.) Purchase Order	<input checked="" type="checkbox"/>

Vendor Number: _____
 Fiscal Year: 2012-2013
 P.O. Under \$50K: _____
 Date Processed: 10-24-2012
 To: MB 10/24 To DR: _____

 Timothy E. White for Date 10/17/12
 Asst. Superintendent

 Tadashi Nakadegawa Date 10/12/12
 Facilities Director

SECTION II. LOCAL BUSINESS PARTICIPATION PERCENTAGE:

Local Business	Small Local Business	Small Local Resident Business	Total Percentage
100.00%		0.00%	100.00%

SECTION III. AGREEMENT INFORMATION:

Project Name:	Claremont Claremont Landscaping	Project No:	07088 <u>2019303891-</u>
Vendor Name:	RMT Landscape Contractors, Inc.	Vendor Contact:	Rick DeHerrera <u>6274</u>
Vendor Phone Number:	(510) 568-3208	Vendor Mailing Address:	7699 Edgewater Drive Oakland, CA 94621
Agreement Start and Stop Dates:	Start: 10/16/2012 Stop: 12/31/2013	Amounts:	Current Contract Amount: \$0.00 Not to Exceed Amount: \$25,080.00 Revised Contract Amount: \$25,080.00
Has Work Started?	<input type="checkbox"/> Yes <input checked="" type="checkbox"/> No If yes give an explanation:	Has Work Been Completed?	<input type="checkbox"/> Yes <input checked="" type="checkbox"/> No Date: <u>5/9/13</u>
Certificate of Insurance Attached <input type="checkbox"/> Yes <input checked="" type="checkbox"/> No		Date provided: _____	

For Construction Contracts >\$15,000, please provide or attach the following:

- 1) Number of Bids Received, List of Bidders and Amounts (Bid Form) (Attach Bid Documents)
- 2) Date(s) of Bid Advertisement -
- 3) Date of Bid Opening -
- 4) Name of Architect -
- 5) Liquidated damages per day - \$

David Kakishima
 President, Board of Education
5/9/13

Scope of Work: (Needed to prepare Executive Summary)

Please attach separately along with Vendor's proposal.

Variety of items for Phase 2 landscaping, including sump pump, new trees, and pavers. This scope was not included in the original landscape project.

Discussion Info: (Needed to prepare Executive Summary) and what is the benefit to students? Add additional pages as needed

(Provide detailed background - Why is contract required)

Per site request, we have compiled a list of additional scope not in the original contract.

Introduction Date: 5-8-2013

Enactment No. 13-0795

Funding Source: ok

Budget Number: 10-24-2012

RECEIVED



LANDSCAPE CONTRACTORS, INC.

7699 Edgewater Drive
Oakland, CA 94621

Contractor's License No. 372869

PROPOSAL & CONTRACT

Name:	Sgi Construction Management	Date:	09/21/12
Attention:	Rocky Borton	Phone:	(510) 535-7076
Address:	360 22nd Street Suite 620 Oakland, Ca.	E-mail:	rborton@sgicm.com
Job Location:	Claremont Middle School- Oakland, Ca.		

Work to be performed as follows:

1) provide and install 1 -1/2hp, 5- gpm pump and bolt down to grate	\$2,500.00
2) grind tree stumps on College	\$865.00
3) install 4- (15) Western Red buds	\$1,000.00
4) re stain curb in big courtyard	\$750.00
5) remove existing pavers and install permeable pavers @ walkway in front of community garded	\$5,975.00
6) patch concrete @ pavers in big courtyard	\$680.00
7) stake (6) redwoods	\$600.00
8) install 6- (5) shrubs @ gate	\$180.00
9) paint controller enclosure	\$50.00
10) install 3- Dumoor benches	\$6,500.00
11) add 50- (1) plants @bioswale area	\$1,000.00
12) remove 1- Liquidambar & stump on College Ave.	\$1,850.00
13) supply & install 5- (15) gal. Wester Red Buds on Miles Ave.	\$1,250.00
14) add 3- (15) gal Western Red Buds on College to replace Liquidambar	\$750.00
15) repair remote control valve and sprinkler head on College	\$500.00
16) drill and poison 3- stumps	\$450.00
17) install 6- (5) gal raphiolepis @ front gate	\$180.00
TOTAL:	\$25,080.00

We agree to supply labor and materials in order to execute the work as outlined above in a workmanlike manner which the owner agrees to pay in accordance with the terms of payment set forth.

TERMS OF PAYMENT:
NET: Payment on Completion

RMT LANDSCAPE CONTRACTORS, INC.

By: _____

Title: President

Accepted by: _____

Date: _____

Owner's Signature: _____

WALK w/ RMT 9.12.12

Claremont Landscape Ph. 2 Bid Scope

1. Provide and install sump pump at DI in garden area-, this was missed on the drawings.
2. 1½ HP w/5 gpm *SPEC - NO. KEY - NO. ELEC CONDUIT*
3. Bolt down to grate at garden to concrete area
4. 6. Grind tree stumps and roots at bldg. on college, roots are not ground down properly and saplings continue to grow.
5. add (4-5) red buds in same area, this is not contract. This is a site request.
6. Re-stain curb at big courtyard, sack and patch has lime seeping through.
7. Change out pavers to permeable pavers at walkway in front of Community Garden, follow paver's specification provided. There is an (E) ponding area, can't fix with elevation change:
NIC 40'x6'
8. Give pavers to site for parents to install (N) path
9. Patch concrete walkway at pavers in big courtyard, small patch from demo work.
10. Check redwoods for vertical
11. Replant plants in front of gate.
12. Paint cage over controller and block wall caps.

Wish List:

ND. SPEC 61-978-6PL
Price to install (N) benches (between rocks) at b-ball area at Bio swale, replace plants and sprinklers at bio swale

Price to remove tree on College, this would include stump grinding & add irrigation (3)

Price (5) trees along Miles ave. *- RD. BUDS 15 GAL.*

Replace missing half wine barrels (6)

VALVE

Eco-Priora™

Concrete Paver Environmental Systems

IMPROVING YOUR LANDSCAPE

Priora



Eco-Priora™

Pavestone Eco-Priora™ is the sustainable solution for permeable pavements. Eco-Priora™ is produced in a 120mm x 240mm rectangular module that is 80mm in thickness with a patented interlocking joint and a micro-chamfered top edge profile. This ingenuity is singular to the Pavestone Eco-Priora™ product and insures optimum pavement performance unequaled in the permeable paver industry. The unique Eco-Priora™ joint profile allows surface water to infiltrate into the pavement and its sub-layers. With initial permeability average flow rates of over 100 inches per hour, the Eco-Priora™ product, even with a clogging factor, will still meet the majority of current storm water management plans (SWMP). The structural interlocking capability is achieved by the paving unit having interlocking joints with a minimum of two vertically aligned horizontal interlocking spacer bars on each of its sides. These spacer bars interlock throughout the depth of the block and nest adjacently with neighboring paving units. This interlocking function resists lateral and vertical displacement when the unit is exposed to load. The dynamics of pavement stress are better distributed providing a structurally superior permeable paving system.

The micro-chamfered top edge profile produces a horizontal edge to edge dimension that is nominally 7mm including installation gapping. This small joint complies dimensionally with current ADA requirements for walking surfaces with spaces no greater than 1/2 inch. This narrow jointed surface diminishes vibration for wheelchairs and shopping carts when compared to all other permeable paving products. Eco-Priora™ can assist in meeting current EPA storm water regulations and LEED certification. The Eco-Priora™ product best achieves the balance of aesthetic segmental paving and the function of permeable pavement.

APPLICATIONS

Parking Lots • Driveways • Patios • Entrance Areas • Sidewalks
Terraces • Garden Pathways • Pool Decks • Pedestrian Malls • Roof Gardens • Streets

COMPOSITION AND MANUFACTURE

Eco-Priora™ is available in one size. Height = 80mm. Eco-Priora™ is made from a "no slump" concrete mix made under extreme pressure and high frequency vibrations. Eco-Priora™ has a compressive strength greater than 8000 psi, a water absorption maximum of 5% and will meet or exceed ASTM C-936. Note: Requires modifying the ASTM C 140 - Paver Annex A4 - "The test specimen shall be 60 ± 3 mm thick and, if necessary, cut to a specimen size having a Height/Thickness (width) [H/T] aspect ratio of 0.6 ± 0.1

INSTALLATION

1. Excavate unsuitable, unstable or unconsolidated subgrade material. Compact the area, which has been cleared as per the engineer's of record (EOR) requirements. Backfill and level with open graded aggregates as per the EOR's structural and hydraulic design.
 2. Place bedding course of hard and angular material conforming to the grading requirements of ASTM No. 8 or No. 9 to a uniform minimum depth of 1 1/2" - 2" (38mm) screeded to the grade and profile required.
 3. Install Eco-Priora™ with joints approximately 1/4" (7mm).
 4. Where required, cut pave stones with an approved cutting device to fit accurately, neatly and without damaged edges.
 5. Tamp pave stones with a plate compactor, uniformly level, true to grade and free of movement.
 6. Spread a thin layer of hard angular material conforming to the grading requirements of ASTM No. 8 or No. 9 aggregate over entire paving area.
 7. Make one more pass with plate compactor to nest the aggregate and fill joints to the top.
 8. Sweep and remove surplus joint material.
- Complete installation & specification details are available by contacting your Pavestone Sales Representative.

Note: Permeable pavements require both civil and hydraulic engineering. All final pavements design shall be approved by a professional engineer familiar with local site conditions, building codes and storm water management plans.



PAVESTONE
Improving Your Landscape™
www.pavestone.com

© 2010 by Pavestone Company. All Rights Reserved. **PAVESTONE**, "Improving Your Landscape" are trademarks of the Pavestone Company. Eco-Priora™ is a trademark of F. von Langsdorff Protected by one or more of the following patents: U.S. Patent 5,902,069 U.S. Patent 6,857,294.

PRODUCT INFORMATION

Eco-Priora™ is available in one size. Height = 80mm

Eco-Priora™

Dimensions: 4 3/4" W x 9 7/16" L x 3 1/8" H

Wt./Stone: 11.5 lbs.

Stones/Pallet: 280

Approx. Wt./Pallet: 3,255 lbs.

Sq. Ft./Pallet: 88

Product Number: 699

ECO-PRIORA™
(120mm x 240mm)



INSTALLATION PATTERN

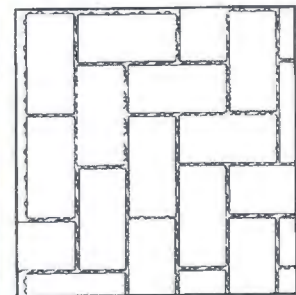

PERMEABLE PAVERS TREATMENT

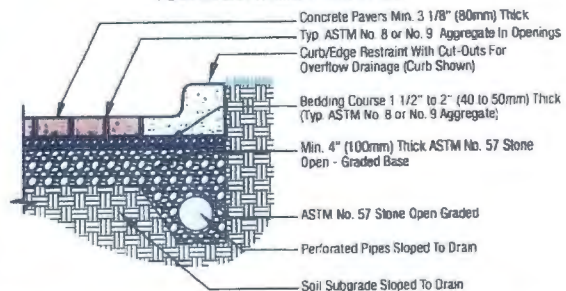

PERMEABLE PAVERS TREATMENT AND DETENTION

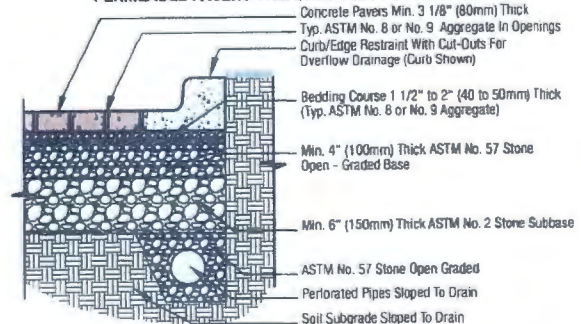

- | | | | |
|---------------------------|----------------|-----------------------|----------------|
| • Atlanta, GA: | (770) 306-9691 | • Houston, TX: | (281) 381-7283 |
| • Austin/San Antonio, TX: | (512) 558-7283 | • Kansas City, MO: | (816) 524-9900 |
| • Boston, MA: | (508) 947-6001 | • Las Vegas, NV: | (702) 221-2700 |
| • Cartersville, GA: | (770) 687-3345 | • New Orleans, LA: | (985) 882-9111 |
| • Charlotte, NC: | (704) 588-4747 | • Phoenix, AZ: | (602) 257-4588 |
| • Cincinnati, OH: | (513) 474-3783 | • St. Louis/ | |
| • Colorado Springs, CO: | (719) 322-0101 | • Cape Girardeau, MO: | (573) 332-8312 |
| • Dallas/Ft. Worth, TX: | (817) 481-5802 | • Sacramento/ | |
| • Denver, CO: | (303) 287-3700 | • Winters, CA: | (530) 795-4400 |
| • Hagerstown, MD: | (240) 420-3780 | | |

Member of ASLA and NCMA



ICPI Charter Member

World Wide

Pavers

Eco-Priora™ 699 Installation Patterns

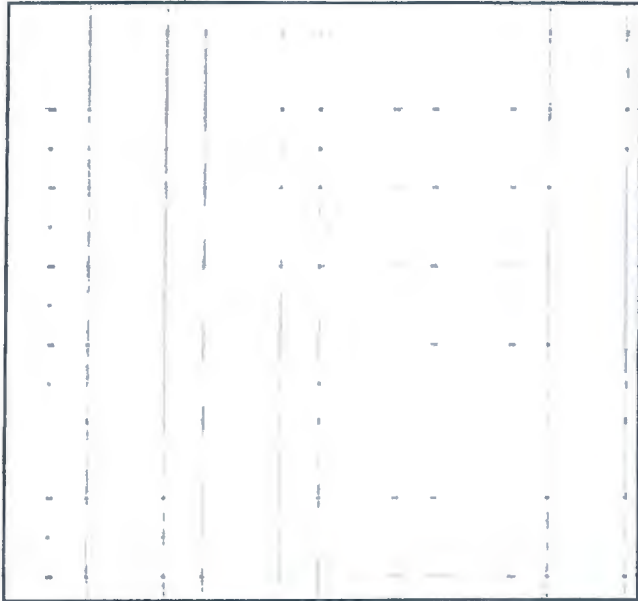

BASKETWEAVE (1)

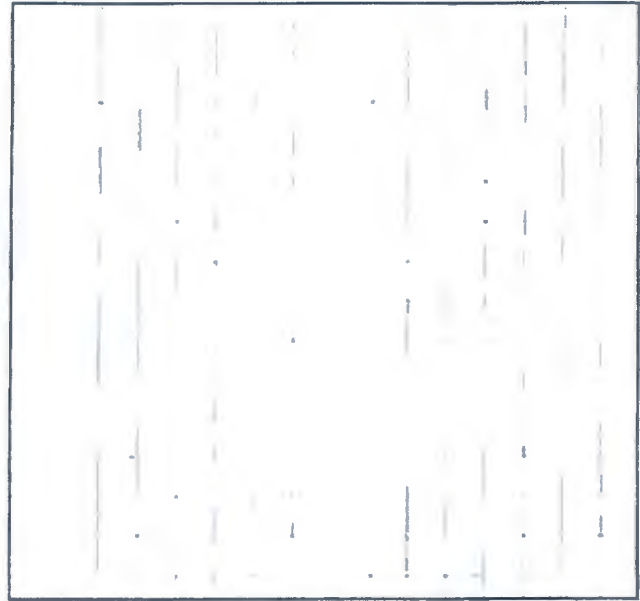

HERRINGBONE (2)

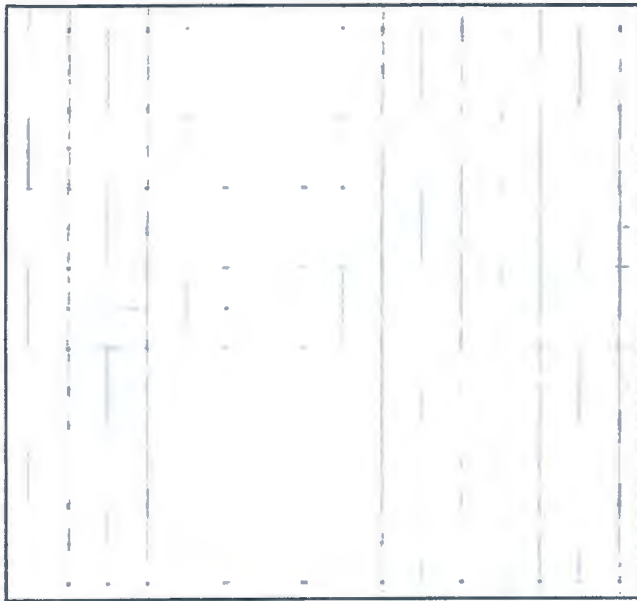

PARQUET (5)

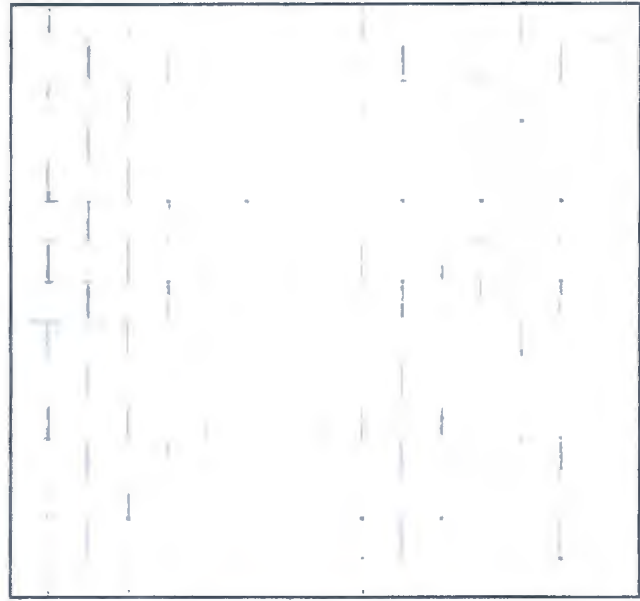

RUNNER BOND (7)

PANGSTONE®
CREATING BEAUTIFUL LANDSCAPES™

Eco-Priora™ 699 Installation Patterns

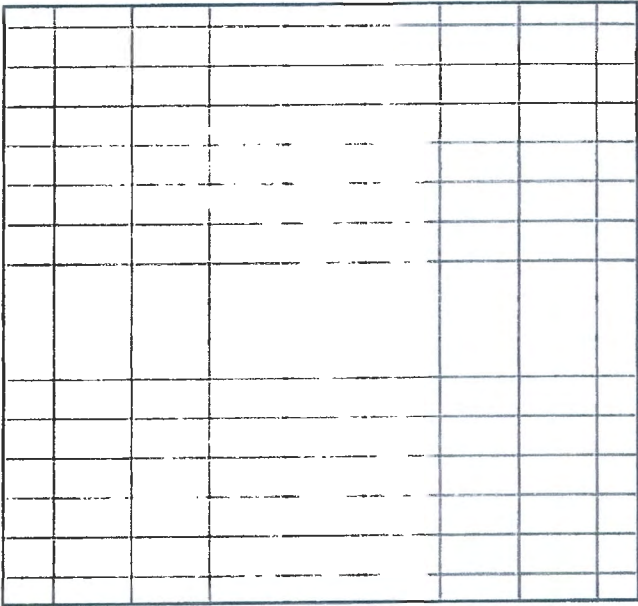

STACK (8)

SECTION 32 14 43

POROUS PAVING

PERMEABLE INTERLOCKING CONCRETE PAVEMENT

PART 1 GENERAL

1.01 SUMMARY

A. Section Includes

1. Permeable concrete pavers.
2. Crushed stone bedding material.
3. Open-graded subbase aggregate.
4. Open-graded base aggregate.
5. Bedding and joint/opening filler materials.
6. Edge restraints.
7. Geotextiles.

B. Related Sections

1. Section 03 30 00: Cast-in-Place Concrete – Edge Restraints.
2. Section 32 11 00: Aggregate base.
3. Section on PVC Drainage pipes
4. Section on Impermeable liner.
5. Section Drainage pipes and appurtenances.
6. Section 31 00 00 Earthworks/excavation/soil compaction.

Contractor shall be responsible for furnishing and installing permeable pavers, base, drainage, perimeter conditions, junction with other materials, expansion and control joints, paver color, installation and setting details shall be per details and plans. Unit Pavers shall be laid out in a staggered bond layout.

1.02 REFERENCES

A. American Society for Testing and Materials (ASTM)

1. C 67, Standard Test Methods for Sampling and Testing Concrete Masonry Units and Related Units.
2. C 131, Standard Test Method for Resistance to Degradation of Small-Size Coarse Aggregate by Abrasion and Impact in the Los Angeles Machine.
3. C 136, Method for Sieve Analysis for Fine and Coarse Aggregate.
4. C 140, Test Methods for Sampling and Testing Brick and Structural Clay Tile, Section 8 – Freezing and Thawing.
5. D 448, Standard Classification for Sizes of Aggregate for Road and Bridge Construction.
6. C 936, Standard Specification for Solid Interlocking Concrete Pavers.
7. C 979, Specification for Pigments for Integrally Colored Concrete.

8. D 698, Test Methods for Moisture Density Relations of Soil and Soil Aggregate Mixtures Using a 5.5-lb (2.49 kg) Rammer and 12 in. (305 mm) drop.
9. D 1557, Test Methods for Moisture Density Relations of Soil and Soil Aggregate Mixtures Using a 10-lb (4.54 kg) Rammer and 18 in. (457 mm) drop.

10. D 1883, Test Method for California Bearing Ratio of Laboratory-Compacted Soils.
11. D 4254, Standard Test Methods for Minimum Index Density and Unit Weight of Soils and Calculation of Relative Density.

C. Interlocking Concrete Pavement Institute (ICPI)

1. Permeable Interlocking Concrete Pavement manual.

1.03 SUBMITTALS

A. In accordance with Conditions of the Contract and Division 1 Submittal Procedures Section.

B. Contractor shall submit the following to the Landscape Architect prior to ordering:

1. Manufacturer's product catalog sheets with specifications.
2. [Four] representative full-size samples of each paver type, thickness, color, and finish. Submit samples indicating the range of color expected in the finished installation.
3. Accepted samples become the standard of acceptance for the work of this Section.
4. Laboratory test reports certifying compliance of the concrete pavers with ASTM C 936.
5. Manufacturer's material safety data sheets for the safe handling of the specified materials and products.
6. Manufacturer's written quality control procedures including representative samples of production record keeping that ensure conformance of paving products to the project specifications.
7. Minimum 3 lb (2 kg) samples of subbase, base and bedding aggregate materials.
8. Sieve analysis of aggregates for subbase, base and bedding materials per ASTM C 136.

C. Paver Installation Subcontractor:

1. A copy of Subcontractor's current certificate from the Interlocking Concrete Pavement Institute Concrete Paver Installer Certification program.
2. Job references from projects of a similar size and complexity. Provide Owner/Client/General Contractor names, postal address, phone, fax, and email address.
3. Written Method Statement and Quality Control Plan that describes material staging and flow, paving direction and installation procedures, including representative reporting forms that ensure conformance to the project specifications.

1.04 QUALITY ASSURANCE

A. Paver Installation Subcontractor Qualifications:

1. Utilize an installer having successfully completed concrete paver installation similar in design, material and extent indicated on this project.
2. Utilize an installer holding a current certificate from the Interlocking Concrete Pavement Institute Concrete Paver Installer Certification program.

B. Review the manufacturers' quality control plan, paver installation subcontractor's Method Statement and Quality Control Plan with pre-construction meeting of representatives from the manufacturer, paver installation subcontractor, general contractor, engineer and/or owner's representative.

- C. Mock-Ups:
 - 1. Install a 10 ft x 10 ft (3 x 3 m) paver area.
 - 2. Use this area to determine surcharge of the bedding layer, joint sizes, lines, laying pattern(s), color(s) and texture of the job.
 - 3. This area will be used as the standard by which the work will be judged.
 - 4. Subject to acceptance by owner, mock-up may be retained as part of finished work.
 - 5. If mock-up is not retained, remove and properly dispose of mock-up.

1.05 DELIVERY, STORAGE, AND HANDLING

- A. General: Comply with Division 1 Product Requirement Section.
- B. Comply with manufacturer's ordering instructions and lead-time requirements to avoid construction delays.
- C. Delivery: Deliver materials in manufacturer's original, unopened, undamaged container packaging with identification tags intact on each paver bundle.
 - 1. Coordinate delivery and paving schedule to minimize interference with normal use of buildings adjacent to paving.
 - 2. Deliver concrete pavers to the site in steel banded, plastic banded, or plastic wrapped cubes capable of transfer by forklift or clamp lift.
 - 3. Unload pavers at job site in such a manner that no damage occurs to the product or existing construction
- D. Storage and Protection: Store materials in protected area such that they are kept free from mud, dirt, and other foreign materials.

1.06 ENVIRONMENTAL REQUIREMENTS

- A. Do not install in rain.

1.07 MAINTENANCE

- A. Extra materials: Provide .5% additional material for use by owner for maintenance and repair.
- B. Pavers shall be from the same production run as installed materials.

PART 2 PRODUCTS

- A. Manufacturer: **PAVESTONE**
 - 1. Contact: **530-795-4400**
- B. Permeable Interlocking Concrete Paver Units:
 - 1. Paver Type: Eco-Priora™
 - a. Material Standard: Comply with ASTM C 936.
 - b. Paver Style: Eco-Priora™ 4 3/4" X 9 1/2" X 3 1/8"
 - c. Color: Old Town Blend
 - d. Color Pigment Material Standard: Comply with ASTM C 979.

2.02 PRODUCT SUBSTITUTIONS

- A. Substitutions: "Approved Equal only as determined by the Landscape Architect".

2.03 CRUSHED STONE FILLER, BEDDING, BASE AND SUBBASE

- A. Crushed stone with 90% fractured faces, LA Abrasion < 40 per ASTM C 131, minimum CBR of 80% per ASTM D 1883.
- B. Do not use rounded river gravel.
- C. All stone materials shall be washed with less than 1% passing the No. 200 sieve. Non-Plasti and free from deleterious or foreign matter
- D. Joint/opening filler, bedding, base and subbase: conforming to ASTM D 448 gradation as shown in Tables 1, 2 and 3 below:

Note: No. 89 or finer gradation may be used to fill permeable pavers with narrow joints.

Table 1 ASTM No. 8 Grading Requirements Bedding and Joint/Opening Filler

	Sieve Size	Percent Passing
1.	12.5 mm (1/2 in.)	100
2.	9.5 mm (3/8 in.)	85 to 100
	4.75 mm (No. 4)	10 to 30
	2.36 mm (No. 8)	0 to 10
	1.16 mm (No. 16)	0 to 5

Table 2 ASTM No. 57 Base Grading Requirements

	Sieve Size	Percent Passing
1.	37.5 mm (1 1/2 in.)	100
2.	25 mm (1 in.)	95 to 100
3.	12.5 mm (1/2 in.)	25 to 60
4.	9.5 mm (3/8 in.)	0 to 15
5.	4.75 mm (No. 4)	0 to 10
6.	2.36 mm (No. 8)	0 to 5

Table 3 Grading Requirement for ASTM No. 2 Subbase Sieve Size	Percent Passing
75 mm (3 in.)	100
63 mm (2 1/2 in.)	90 to 100
50 mm (2 in.)	35 to 70
37.5 mm (1 1/2 in.)	0 to 15
19 mm (3/4 in.)	0 to 5

E. Gradation criteria for the bedding and base:

Note: D_x is the particle size at which x percent of the particles are finer. For example, D_{15} is the particle size of the aggregate for which 15% of the particles are smaller and 85% are larger.

1. D_{15} base stone / D_{50} bedding stone < 5.
2. D_{50} base stone / D_{50} bedding stone > 2.

F. Micro-Deval Degradation of less than 8%. Soft Aggregates such as limestone can not be used as they will lead to total system failure.

2.04 ACCESSORIES

A. Provide accessory materials as follows:

1. Edge Restraints
 - a. Concrete Cast-in-Place.
2. Geotextile Fabric:
 - a. Material Type and Description: Per Geotechnical Report.
 - b. Material Standard: Per Geotechnical Report.
 - c. Manufacturer: Per Geotechnical Report.

PART 3 EXECUTION

3.01 ACCEPTABLE INSTALLERS

A. Installers with 5 years or more installing similar paving systems.

3.02 EXAMINATION

A. Acceptance of Site Verification of Conditions:

1. General Contractor shall inspect, accept and certify in writing to the paver installation subcontractor that site conditions meet specifications for the following items prior to installation of interlocking concrete pavers.
 - a. Subgrade shall be placed as indicated on the plans and compacted to a minimum 95% density and elevations conform to specified requirements or as recommended by Engineer.
 - b. Contractor shall provide written density test results for soil subgrade to the Owner, General Contractor and paver installation subcontractor.
 - c. Verify location, type, and elevations of edge restraints, utility structures, and drainage pipes and inlets.
2. Do not proceed with installation of bedding and permeable concrete pavers until subgrade soil conditions are installed properly.

3.03 PREPARATION

- A. Verify that the soil subgrade is free from standing water.
- B. Stockpile joint/opening filler, base and subbase materials such that they are free from standing water, uniformly graded, free of any organic material or sediment, debris, and ready for placement.
- C. Edge Restraint Preparation:
 1. Install concealed edge restraints per the drawings and at the elevations required to provide proper elevation of Finished Grade of Pavers.

3.04 INSTALLATION

Note: The minimum slope of the soil subgrade should be 0.5%. Actual slope of soil subgrade will depend on the drainage design and exfiltration type. All drainpipes, observation wells, overflow pipes, geotextile (if applicable) and impermeable liner (if applicable) should be in place per the drawings prior to or during placement of the subbase and base, depending on their location. Care must be taken not to damage drainpipes during compaction and paving. No mud or sediment can be left on the base or bedding aggregates. If they are contaminated, they must be removed and replaced with clean materials.

- A. General
 1. Any excess thickness of soil applied over the excavated soil subgrade to trap sediment from adjacent construction activities shall be removed before application of the Geotextile per Geotechnical Report and subbase materials.
 2. Keep area where pavement is to be constructed free from sediment during entire job. Geotextiles per Geotechnical Report Base and bedding materials contaminated with sediment shall be removed and replaced with clean materials.
 3. Do not damage drainpipes, overflow pipes, observation wells, or any inlets and other drainage appurtenances during installation. Report any damage immediately to the project engineer.
- B. Geotextiles
 1. Place on bottom and sides of soil subgrade. Secure in place to prevent wrinkling from vehicle tires and tracks.
 2. Overlap a minimum of [0.3 in (12 in.)] [0.6 m (24 in.)] in the direction of drainage.
- C. Open-graded subbase and base
 1. Moisten, spread and compact the No. 2 subbase in 4 to 6 in. (100 to 150 mm) lifts [without wrinkling or folding the geotextile. Place subbase to protect geotextile from wrinkling under equipment tires and tracks.]

2. For each lift, make at least two passes in the vibratory mode then at least two in the static mode with a minimum 10 t (10 T) vibratory roller until there is no visible movement of the No. 2 stone. Do not crush aggregate with the roller.
3. The surface tolerance of the compacted No. 2 subbase shall be $\pm 2 \frac{1}{2}$ in. (± 65 mm) over a 10 ft (3 m) straightedge.
4. Moisten, spread and compact No. 57 base in 100 mm (4 in.) lift over the compacted No. 2 subbase with a minimum 10 t (10 T) vibratory roller until there is no visible movement of the No. 57 stone. Do not crush aggregate with the roller.
5. The surface tolerance the compacted No. 57 base should not deviate more than ± 1 in. (25 mm) over a 10 ft (3 m) straightedge.

Note: In-place density of the base and subbase may be checked per ASTM D 4254. Compacted density should be 95% of the laboratory index density established for the subbase and base stone.

D. Bedding layer

1. Moisten, spread and screed the No. 8 stone bedding material.
2. Fill voids left by removed screed rails with No. 8 stone.
3. The surface tolerance of the screeded No. 8 bedding layer shall be $\pm 3/8$ in (10 mm) over a 10 ft (3 m) straightedge.
4. Do not subject screeded bedding material to any pedestrian or vehicular traffic before paving unit installation begins.

E. Permeable interlocking concrete pavers and joint/opening fill material

1. Lay the pavers [paving slabs] in the pattern(s) and joint widths shown on the drawings. Maintain straight pattern lines.
2. Fill gaps at the edges of the paved area with cut units. Cut pavers subject to tire traffic shall be no smaller than 1/3 of a whole unit.
3. Cut pavers and place along the edges with a [double-bladed splitter or] masonry saw.
4. Fill the openings and joints with [No. 8] stone.

Note: Some paver joint widths may be narrow and not accept most of the No. 8 stone. Use joint material that will fill joints such as washed ASTM No. 9 or No. 10 stone. These smaller stone sizes are recommended for filling joints in pedestrian applications that use 2 3/8 in. (60 mm) thick pavers.

5. Remove excess aggregate on the surface by sweeping pavers clean.
6. Compact and seat the pavers into the bedding material using a low-amplitude, 7590 Hz plate compactor capable of at least 4,000 lbs (18 kN) centrifugal compaction force. This will require at least two passes with the plate compactor.
7. Do not compact within 6 ft (2 m) of the unrestrained edges of the paving units.
8. Apply additional aggregate to the openings and joints, filling them completely. Remove excess aggregate by sweeping then compact the pavers. This will require at least two passes with the plate compactor.
9. All pavers within 6 ft (2 m) of the laying face must be left fully compacted at the completion of each day.
10. The final surface tolerance of compacted pavers shall not deviate more than $\pm 3/8$ (10 mm) under a 10 ft (3 m) long straightedge.
11. The surface elevation of pavers shall be 1/8 to 1/4 in (3 to 6 mm) above adjacent drainage inlets, concrete collars or channels.

3.05 FIELD QUALITY CONTROL

- A. After sweeping the surface clean, check final elevations for conformance to the drawings.
- B. Lippage: No greater than 1/8 in. (3 mm) difference in height between adjacent pavers.

Note: The minimum slope of the finished pavement surface should be 1%. The surface of the

pavers may be 1/8 to 1/4 in. (3 to 6 mm.) above the final elevations after compaction. This helps compensate for possible minor settling normal to pavements.

- C. The surface elevation of pavers shall be 1/8 to 1/4 in. (3 to 6 mm) above adjacent drainage inlets, concrete collars or channels.



3.06 PROTECTION

- A. After work in this section is complete, the General Contractor shall be responsible for protecting work from sediment deposition and damage due to subsequent construction activity on the site.

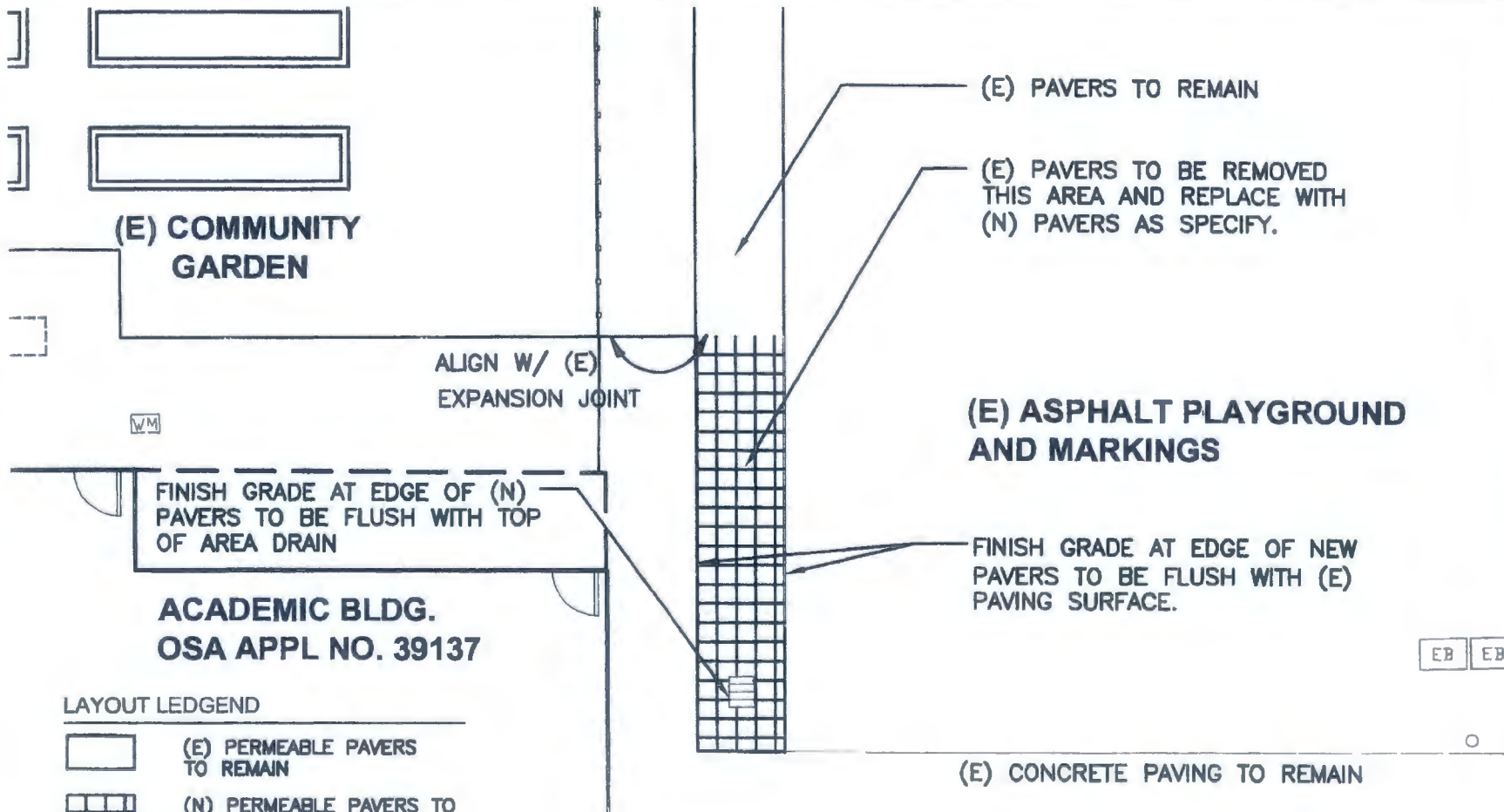
END OF SECTION 32 14 43



LAYOUT LEDGEND

-  (E) PERMEABLE PAVERS TO REMAIN
-  (N) PERMEABLE PAVERS TO INSTALL, PATTERN TO MATCH (E) PATTERN
-  (E) CONCRETE PAVING TO REMAIN

1 LAYOUT PLAN FOR (N) PAVER INSTALLATION
SCALE: 1" = 10'



LANDSCAPE ARCHITECTURE
URBAN DESIGN & PLANNING
4400 MARKET STREET
OAKLAND, CA 94603
c. 510 488 4290
f. 510 488 8325
88001828 CA 16 05031



CLAREMONT MIDDLE SCHOOL
5750 COLLEGE AVE,
OAKLAND, CA

Client / Developer:
OAKLAND UNIFIED SCHOOL DISTRICT
1025 2ND AVENUE
OAKLAND, CA 94606

LAYOUT PLAN -
(N) PAVER INSTALLATION
SCALE: 1"=10'-0"
DATE: MARCH 12, 2011

LL-1

TADASHI OK (ORDER 3) @ \$1,235 EA.

EMAILED TO RMT 9.17.12

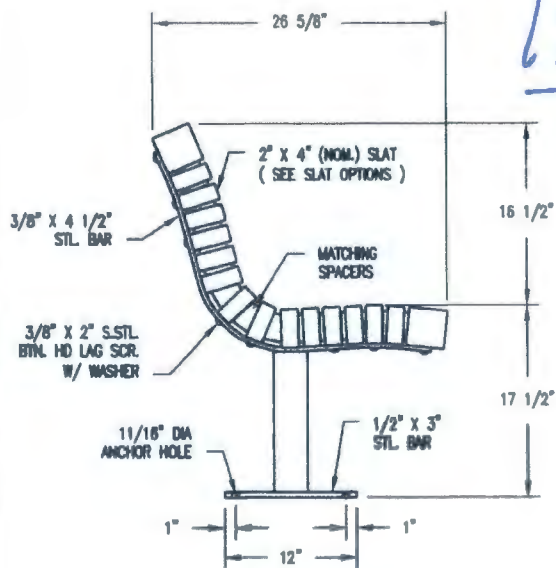

S-2 SURFACE

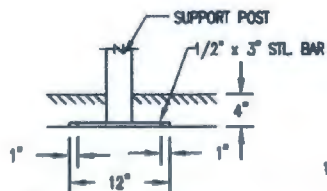

S-4 SUB FLOOR

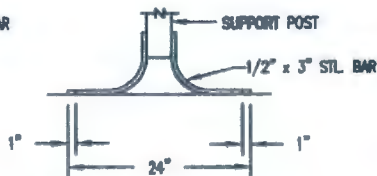

S-3 GULL WING

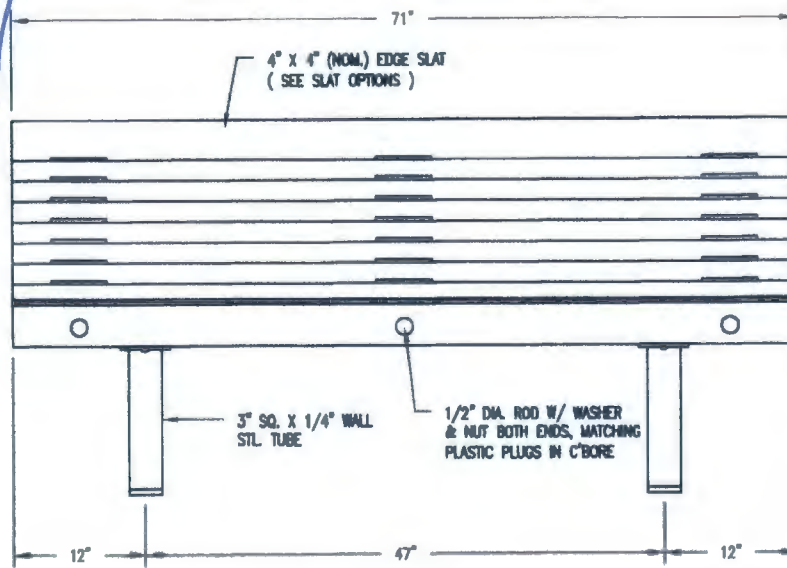

SLAT OPTIONS

- "CEDAR" RECYCLED PLASTIC
- "GREY" RECYCLED PLASTIC
- "REDWOOD" RECYCLED PLASTIC
- "WALNUT" RECYCLED PLASTIC
- OTHER _____

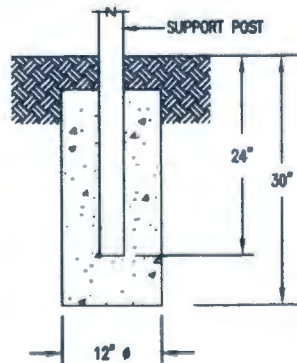

S-1 EMBEDMENT

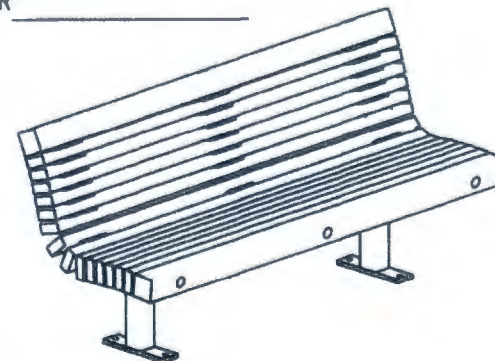

NOTES

- 1.) ALL STL. MEMBERS COATED W/ ZINC RICH EPOXY THEN FINISHED W/ POLYESTER POWDER COATING.
- 2.) 1/2" x 3 3/4" EXPANSION ANCHOR BOLT PROVIDED FOR S-2, S-3 & S-4 OPTIONS.

DuMor, inc.
 P.O. Box 142 Mifflintown, PA 17068-0142

DATE DRAWN : 3/21/94
 DRAWN BY : HD
 DATE REV. : 11/03/11
 REV. BY : ESS

TITLE

BENCH

REVISION

C

DRAWING NUMBER

61-978-6PL

AMENDMENT INDEPENDENT CONTRACT ROUTING FORM

Project Information			
Project Name	Claremont Landscaping	Site	Claremont
Basic Directions			
Services cannot be provided until the contract is fully approved and a Purchase Order has been issued.			
Attachment Checklist	<input type="checkbox"/> Proof of general liability insurance, including certificates and endorsements, if contract is over \$15,000 <input type="checkbox"/> Workers compensation insurance certification, unless vendor is a sole provider		

Contractor Information					
Contractor Name	RMT Landscape Contractors, Inc.	Agency's Contact	Rick DeHarrera		
OUSD Vendor ID #	I01404	Title	Project Manager		
Street Address	7699 Edgewater Drive	City	Oakland	State	CA Zip 94621
Telephone	510-568-3208	Policy Expires	10-1-2013		
Contractor History	Previously been an OUSD contractor? x Yes <input type="checkbox"/> No		Worked as an OUSD employee? <input type="checkbox"/> Yes x No		
OUSD Project #	07088				

Term			
Date Work Will Begin	10-16-2012	Date Work Will End By <small>(not more than 5 years from start date)</small>	12-31-2013

Compensation			
Total Contract Amount	\$	Total Contract Not To Exceed	\$ 42,892.00
Pay Rate Per Hour (If Hourly)	\$	If Amendment, Changed Amount	\$ 8,700.00
Other Expenses		Requisition Number	

Budget Information				
<i>If you are planning to multi-fund a contract using LEP funds, please contact the State and Federal Office before completing requisition.</i>				
Resource #	Funding Source	Org Key	Object Code	Amount
0000	Measure A	2019303891	6130	\$8,700.00

Approval and Routing (in order of approval steps)				
Services cannot be provided before the contract is fully approved and a Purchase Order is issued. Signing this document affirms that to your knowledge services were not provided before a PO was issued.				
1.	Division Head – Tadashi Nakadegawa	510-535-7038	Fax	510-535-7082
	Director, Facilities Planning and Management	 Date Approved 7/16/13		
2.	General Counsel, Department of Facilities Planning and Management			
	Associate Superintendent, Facilities Planning and Management	 Date Approved 7-16-13		
3.	Signature			
	President, Board of Education			
4.	Signature	Date Approved		