



# OAKLAND UNIFIED SCHOOL DISTRICT

Community Schools, Thriving Students

## Project Fact Sheet

April 2015

### Madison Middle School Expansion Project



Aerial View of Site

#### **Project Location**

400 Capistrano Dr, Oakland, CA 94603

#### **Current Status**

- Design (New Building)
- Construction (Modular Classrooms)

#### **Construction Schedule**

May 2016 - August 2017  
May 28, 2015 - August 15, 2015

#### **Architect**

Byrens Kim Design Works

#### **Contractor**

Arntz/Focon - Joint Venture  
Ray's Electric

#### **Funding/Budget**

Measure J / \$27,000,000

#### **Project Scope**

Summer 2015: Installation of two (2) temporary modular classroom buildings including but not necessarily limited to: electrical service, fire alarm, intrusion alarm, intercom/phone/clock/PA, asphaltic ramp, chain link fencing, painting, and plumbing. The modular classroom buildings currently serving as the high school will be removed once construction ends on the new building.

May 2016 - August 2017: Construction of a new building to accommodate the high school program at the Madison Campus. The new high school classroom building will include 14 classrooms, 2 labs, 6 offices, and a new kitchen in addition to other staff work spaces. The site will also include 120+/- new parking spaces.

#### **Project Update**

Ray's Electric is the low bidder on the modular installation project. Design is ongoing for the new high school building.

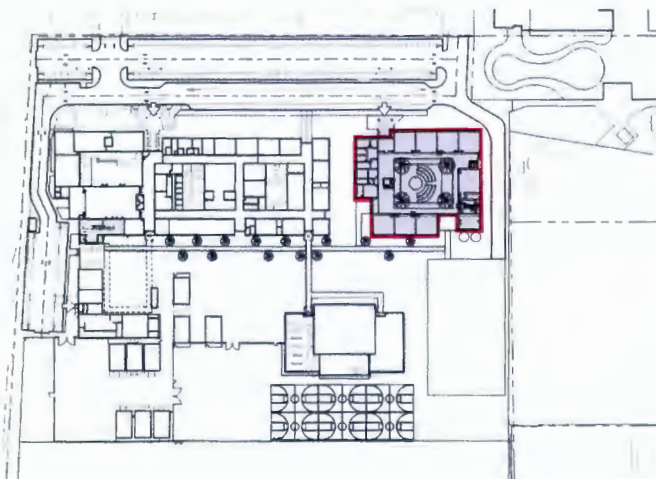

Site plan with new building (outlined in red)



Current modular classroom buildings



## OAKLAND UNIFIED SCHOOL DISTRICT

Community Schools, Thriving Students

# Project Fact Sheet

April 2015

## Greenleaf at Whittier Elementary School

Expansion Project



Conceptual Rendering of Site

**Project Location**  
6328 E 17th Street  
Oakland, CA 94621

**Current Status**  
Pre-construction  
(Phase I)

**Construction Schedule**  
June 2015 - December  
2017

**Architect**  
Gelfand Partners

**Contractor**  
Cahill / Focon - Joint  
Venture

**Funding/Budget**  
Measure J / \$28.0 M

### Project Scope

The scope of this project consists of new construction and upgrades to existing systems to support a site grade expansion from K-5 to TK-8. This includes a new two story building adjacent to the existing academic building, a multipurpose and flex classroom building, four new modular kindergarten rooms, and seismic, HVAC, plumbing, lighting and finish upgrades at the existing building. The new multipurpose building will replace the existing basement cafeteria and auditorium. The modular kindergarten rooms will accommodate three kindergarten classes and one transitional kindergarten class.

This project will be split up into 3 construction phases, starting summer 2015 and concluding fall 2017:

**Phase 1:** Demolition of existing portables and multipurpose building, site improvements, installation of new interim housing portables, modular buildings and play structure.

**Phase 2:** Construction of the new two story building, which includes administration offices, 6 classrooms and a library.

**Phase 3:** Modernization of the existing academic building as described above, removal of the new interim housing portables, and conclusion of all remaining site work.

### Project Update

Pre-construction meetings for Phase I were held 3/5/15 and 4/14/15. Phase I DSA backcheck is scheduled for 4/30/15. Fabrication of the modular buildings has begun and Cahill / Focon - Joint Venture is engaged in the play structure and equipment procurement process. DSA review is underway for Phases 2 and 3.